







**wichtige
Strassenquerungen**

-  Fussgänger LSA
-  Fussgängerstreifen
-  «Füessli»-Markierung
-  Querungshilfe geplant

Legende

-  Hauptschulweg
-  Schulhaus Islikon
-  Tempo-30-Zone

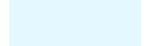
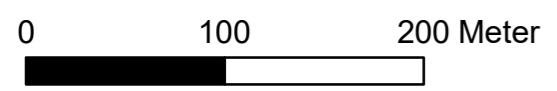
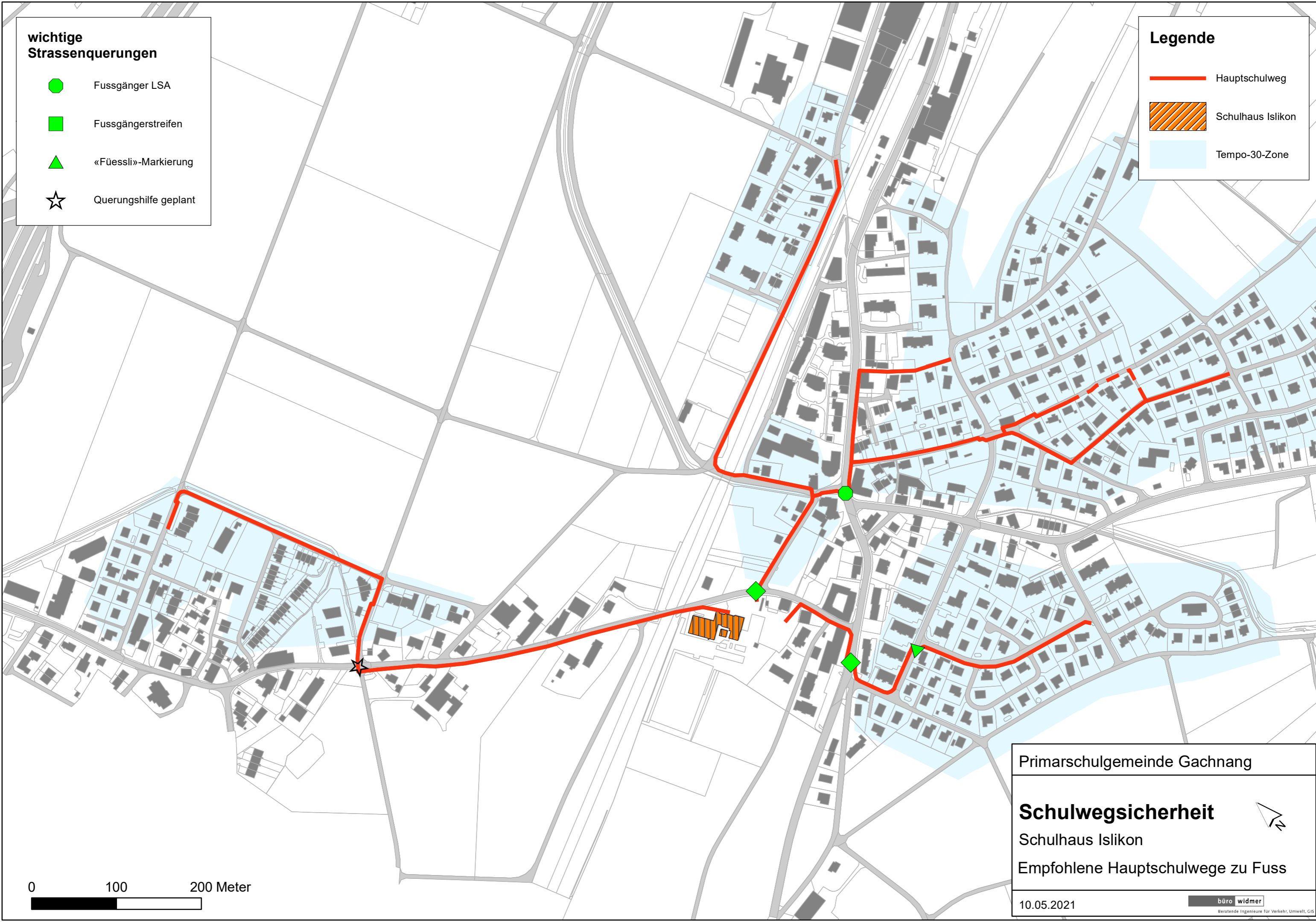

Primarschulgemeinde Gachnang

Schulwegsicherheit 

Schulhaus Islikon

Empfohlene Hauptschulwege zu Fuss

10.05.2021 

Beratende Ingenieure für Verkehr, Umwelt, GIS